

# HZ Series 85°C Withstanding Vibration(耐振动)

- Long Life,2000 hours at 85°C(U<sub>R</sub>,I<sub>R</sub> applied)
- Withstanding Vibration
- Designed for withstanding vibration
- RoHS Compliant



## SPECIFICATIONS AND CHARACTERISTICS IN BRIEF

Item	Performance Characteristics									
Standard	IEC 60384-4									
Temperature Range	-40°C (10V to 250V)、-25°C (315V to 550V) to +85°C (Operating) -55°C to +105°C (Storage)									
Rated Working Voltage Range U <sub>R</sub>	10V to 550V									
Surge Voltage U <sub>s</sub>	1.10 x U <sub>R</sub> (for U <sub>R</sub> > 250 VDC), 1.15 x U <sub>R</sub> (for U <sub>R</sub> ≤ 250 VDC)									
Nominal Capacitance Range	56µF to 82000 µF									
Capacitance Tolerance	±20% (120Hz, +20°C)									
Leakage Current I <sub>L</sub>	= 0.01 x C <sub>R</sub> x U <sub>R</sub> (µA) or 6mA whichever is the smaller. Note, C <sub>R</sub> is in µF.					Test Condition: U <sub>R</sub> , 5mins., 20°C				
Characteristics at low Temperature	Max. impedance ratio at 120 Hz	U <sub>R</sub> (V)		10~100	160~250	315~385	400~450	500~550		
		Z -25 °C / Z 20 °C		4	4	6	8	8		
		Z -40 °C / Z 20 °C		15	15	-	-	-		
tan δ	Working Voltage(V)	10	16	25	35	50	63	80	100	160~550
	tan δ(max) (120Hz, +20°C)	0.55	0.50	0.45	0.40	0.35	0.30	0.25	0.20	0.20
Operational Life Time +85°C, U <sub>R</sub> , I <sub>R</sub>	Can Diameter					End of Life Requirement:				
	20,22,25	2000 hrs				ΔC/C ≤ ±20%				
+85°C, U <sub>R</sub>	Can Diameter					tan δ ≤ 2 x initial tan δ value				
	20,22,25	4000 hrs				I <sub>L</sub> ≤ initial specified limi				
Shelf Life +85°C	After leaving capacitors under no load at 85°C for 1000 hours, Capacitors shall meet specified value for load life characteristics listed above.									
	Others									
If the capacitors are stored more than 1 year, the Leakage Current may increase. Please apply voltage through about 1 kΩ resistor, if necessary.										

## SPECIFICATIONS

Unit:mm

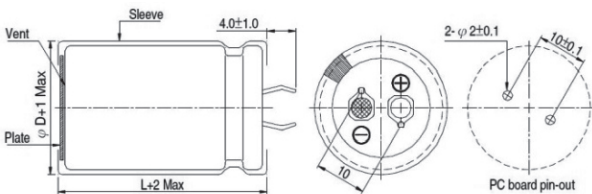

## RIPPLE CURRENT MULTIPLIER

Freq(HZ)	50	120	1K	10K	100K
Coefficient	0.80	1.00	1.20	1.35	1.40

### Mounting

These capacitors are designed to be mounted by their terminations alone, and may be used in any position.

# HZ Series 85°C Withstanding Vibration(耐振动)

STANDARD RATINGS								
Voltage (V)	10		16		25		35	
	Case Size	Ripple Current	Case Size	Ripple Current	Case Size	Ripple Current	Case Size	Ripple Current
2700							20×25	1.76
3300							20×30	2.14
3900							20×30	2.28
4700					20×25	2.18	20×35	2.48
5600					20×30	2.33	22×35	2.79
6800			20×25	2.33	22×30	2.33	22×40	2.89
8200			20×30	2.56	20×40	2.91	22×45	3.47
			22×25	2.56	22×35	2.81	25×35	3.33
10000	20×30	2.44	20×35	2.85	22×35	3.18	22×50	3.59
	22×25	2.41	22×30	2.81	25×30	3.16	25×40	3.59
12000	30×30	2.44	22×30	3.13	22×40	3.53	25×45	4.01
	22×25	2.41	25×25	2.96	25×35	3.48	30×35	4.01
15000	20×35	2.90	22×35	3.69	22×50	4.08	30×40	4.80
	22×30	2.88	25×30	3.64	25×40	4.00	35×35	4.08
18000	22×35	3.22	22×40	3.98	25×45	4.68	30×45	5.18
	25×30	3.08	25×35	3.98	30×35	4.68	35×40	5.71
22000	22×40	3.79	25×40	4.44	30×40	5.19	35×45	6.38
	25×30	3.68	30×30	4.38	35×35	5.20		
27000	22×45	4.04	25×45	4.98	30×45	6.02	35×50	6.90
	25×35	4.04	30×35	4.82	35×40	6.02		
33000	25×40	4.56	25×50	5.49	35×45	6.75		
	30×30	4.58	30×40	5.38				
39000	25×45	5.29	30×45	6.11	35×50	7.56		
	30×35	5.21	35×35	6.01				
47000	30×40	5.78	30×50	6.80				
	35×35	5.55	35×40	6.80				
56000	30×45	6.59	35×45	7.62				
68000	30×50	7.50						
	35×40	7.48						
82000	35×50	8.50						

Maximum Allowable Ripple Current (A rms) at 85°C 120HZ

Case Size ΦD×L(mm)

# HZ Series 85°C Withstanding Vibration(耐振动)

STANDARD RATINGS								
Voltage (V)	400		450		500		550	
	Case Size	Ripple Current	Case Size	Ripple Current	Case Size	Ripple Current	Case Size	Ripple Current
56			20×25	0.58				
68	20×25	0.71	20×30	0.67				
82	20×30	0.78	20×35	0.76				
100	25×30	0.90	20×35	0.84	25×30	0.90	30×40	0.98
120	25×35	1.08	20×40	0.94	30×30	1.00	30×40	1.07
150	22×35	1.18	22×40	1.12	30×35	1.20	30×40	1.26
	25×40	1.21	25×35	1.19				
180	30×35	1.45	22×50	1.26	30×40	1.40	35×40	1.55
		1.56	25×40	1.33	35×30	1.30		
220	22×45	1.50	25×45	1.51	30×45	1.60	35×45	1.61
	25×35	1.56	30×35	1.56	35×35	1.50		
270	25×40	1.70	25×50	1.65	30×50	1.80	35×50	1.79
	30×35	1.73	30×40	1.80	35×40	1.70		
330	25×50	1.90	30×45	2.02	35×45	2.00	35×50	2.28
	30×40	1.95		2.05				
	35×30	1.95						
390	30×40	2.15	30×50	2.24	35×50	2.30		
	35×35	2.17	35×40	2.27				
470	30×50	2.39	35×45	2.55				
	35×40	2.42						
560	35×45	2.71						
680	35×50	2.95						

Maximum Allowable Ripple Current (A rms) at 85°C 120HZ

Case Size ΦD×L(mm)

Specifications are subject to change without notice. Should a safety or technical concern arise regarding the product, please be sure to contact our sales offices or agents immediately.

# HZ Series 85°C Withstanding Vibration(耐振动)

STANDARD RATINGS								
Voltage (V)	160		200		250		350	
	Case Size	Ripple Current	Case Size	Ripple Current	Case Size	Ripple Current	Case Size	Ripple Current
120							20×30	0.91
150							20×35	1.05
180					20×25	1.14	20×40	1.18
220			20×25	1.13	20×30 22×25	1.20 1.18	22×40 25×35	1.40 1.46
270	20×25	1.22	20×30	1.32	20×30	1.35	22×45	1.62
330	20×30	1.48	20×30 22×25	1.49 1.44	20×35 22×30	1.60 1.58	22×50 25×40	1.78 1.88
390	20×30 22×25	1.55 1.55	20×35 22×30	1.66 1.65	20×40 22×35	1.83 1.79	25×45 30×35	2.04 2.12
470	20×35 22×30	1.81 1.77	20×40 22×35	1.93 1.88	22×40 25×35	2.05 2.05	30×40	2.41
560	20×40 22×35	2.04 2.05	22×40 25×30	2.08 2.05	22×45 25×35	2.36 2.24	30×45	2.60
680	22×40 25×30	2.24 2.22	22×45 25×35	2.36 2.36	25×40 30×35	2.54 2.58	35×40	3.00
820	22×45 25×35	2.55 2.52	22×50 25×40	2.68 2.68	25×50 30×35	2.87 2.84	35×50	3.30
1000	22×50 25×40	2.88 2.86	25×45 30×35	3.12 3.00	30×45 35×35	3.39 3.31		
1200	25×45 30×35	3.27 3.25	25×50 30×40	3.44 3.44	30×50 35×40	3.80 3.68		
1500	30×40 30×35	3.77 3.75	30×50 35×40	3.93 3.83	35×45	4.12		
1800	30×45 35×35	4.10 4.08	35×45	4.37	35×50	4.31		
2200	35×45	4.72	35×50	5.00				
2700	35×50	5.30						

Maximum Allowable Ripple Current (A rms) at 85°C 120HZ

Case Size ΦD×L(mm)

# HZ Series 85°C Withstanding Vibration(耐振动)

STANDARD RATINGS								
Voltage (V)	50		63		80		100	
Cap (μF)	Case Size	Ripple Current	Case Size	Ripple Current	Case Size	Ripple Current	Case Size	Ripple Current
680							20×25	1.66
820							22×25	1.86
1000					20×25	1.56	20×35	2.02
1200					20×30	1.80	20×40	2.12
					22×25	1.77	22×30	2.12
1500			20×25	1.69	20×35	2.10	22×35	2.45
1800	20×25	1.70	20×30	2.04	20×40	2.30	22×40	2.77
			22×25	1.90	22×35	2.25	25×35	2.77
2200	20×30	2.07	20×35	2.40	22×40	2.53	22×45	3.12
	22×25	1.93	22×30	2.35	25×30	2.53	25×40	3.20
2700	20×35	2.21	20×40	2.52	22×45	2.93	25×45	3.61
	22×30	2.21	22×35	2.50	25×35	2.93	30×35	3.60
3300	20×40	2.41	22×40	2.69	22×50	3.25	25×50	4.08
	22×30	2.41	25×30	2.69	25×40	3.25	30×40	4.05
3900	22×35	2.72	22×45	3.10	25×45	3.62	30×45	4.60
	25×30	2.68	25×35	3.09	30×35	3.62	35×35	4.50
4700	22×40	3.01	22×50	3.49	25×50	4.28	30×50	5.13
	25×30	2.68	25×40	3.37	30×40	4.15	35×40	5.12
5600	22×45	3.43	25×45	3.80	30×45	4.55	35×45	5.73
	25×35	3.37	30×35	3.81	35×35	4.51		
6800	25×40	3.87	25×50	4.41	30×50	5.18	35×50	6.01
	30×35	3.87	30×40	4.41	35×40	5.14		
8200	25×45	4.37	30×45	4.90	35×45	5.83		
	30×35	3.87	35×35	4.80				
10000	30×40	5.02	30×50	5.49				
	35×35	4.92						
12000	30×50	5.60	35×50	6.30				
	35×40	5.60						
15000	35×45	6.44						
18000	35×50	6.71						

Maximum Allowable Ripple Current (A rms) at 85°C 120HZ

Case Size ΦD×L(mm)